

C-HVRCF12PCX

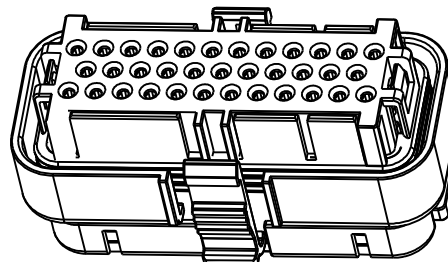

IDENTIFICATION MARK
KEY A = WHITE
KEY B = YELLOW
KEY C = RED

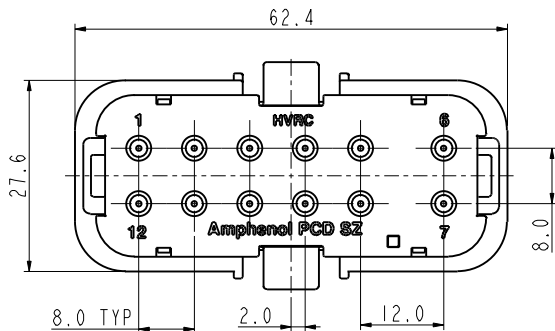
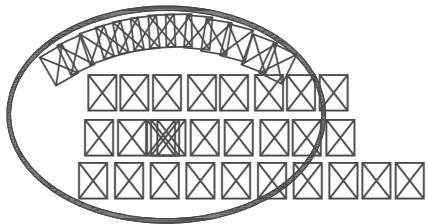
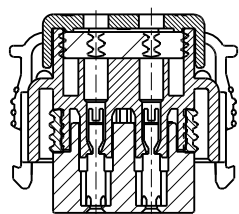

SECTION A-A

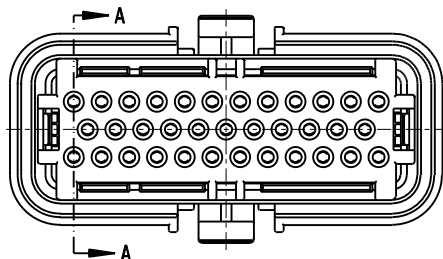
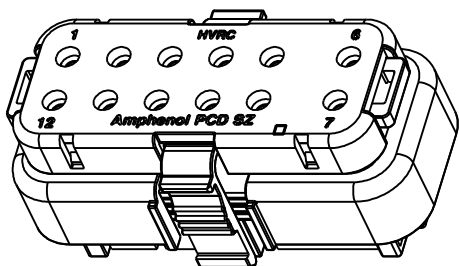
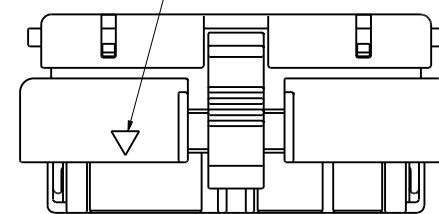
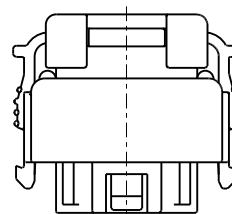
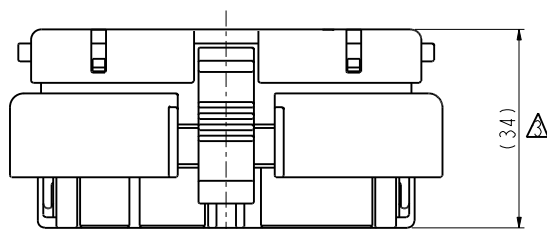

✦: IS CRITICAL CHARACTERISTIC SYMBOL,
⊙: IS IMPORTANT CHARACTERISTIC SYMBOL.

TECHINCAL DATA		SPECIAL CHARACTERISTICS SYMBOL
VOLTAGE RATING	800VAC	✦
CURRENT RATING	5A(22~18AWG)	✦
WIRE RANGE	22-18AWG WIRE INSULATION OD: 1.35-2.5MM	NA
WATERPRROF (MATED CONDITION)	IP 67	✦
OPERATION TEMP.	-40-125°	NA
MAX MATING CYCLES	50 TIMES	⊙

- NOTES:
- ✦ 1. MATERIAL: HOUSING PA66 UL94 V-0, SEAL SILICONE.
 - ✦ 2. MATE CONTACT AND SEAL SEE BELOW TABLE, CONTACT AND SEAL SHOULD BE ORDERED SEPARATELY. MATE CONNECTOR P/N: HVRCM12SCRX.
 - ⚠ THE GRAY HOUSING CANNOT BE INSERTED INTO SHELL DEEPER BEFORE INSTALL CONTACTS.
 - ✦ 4. ROHS COMPLIANCE.

安费诺精密连接器(深圳)有限公司
Amphenol PCD Shenzhen
受控文件
2019年10月10日

USED WITH CONTACT AND SEAL TYPE	
CONTACT P/N	SEAL P/N
C310023101	C220011207

DIMENSIONS	TOLERANCES	PROJECTION	TITLE			
ANSI Y14.5M UNITS: MM Pro/E FILE	.X ±0.5 .XX ±0.05 ANGLES ±2.0°		HVRC SERIES PLUG			
ORIGINAL	THIS DOCUMENT CONTAINS PROPRIETARY INFORMATION WHICH IS THE CONFIDENTIAL PROPERTY OF AMPHENOL PCD SHENZHEN		ENGR	CHKD	APPD	SIZE A3
						DWG NO. C-HVRCF12PCX
						REV 1
						CODE: 58982
						SCALE: 13:10
						SHEET 1 OF 2

C-HVRCF12PCX

C-HVRCF12PCX

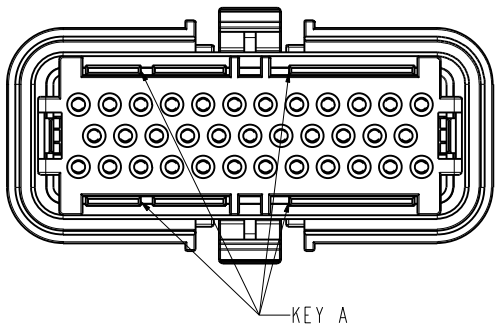

KEY A

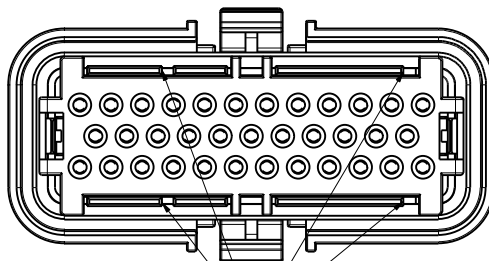

KEY B

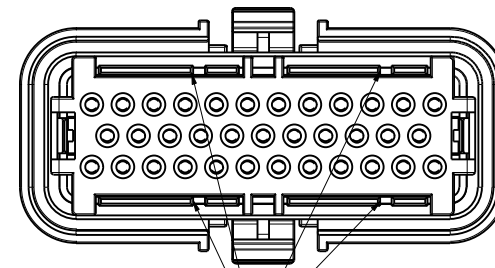

KEY C

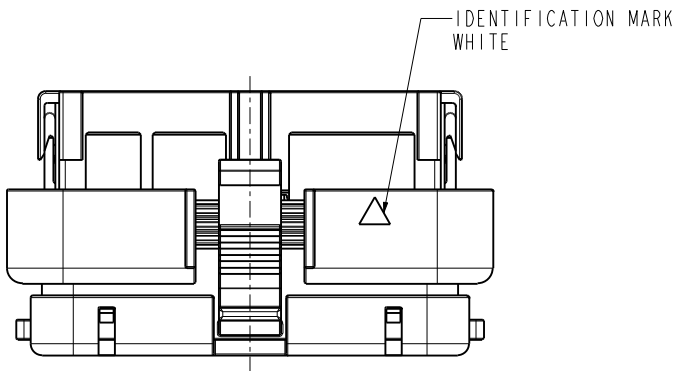

IDENTIFICATION MARK
WHITE

HVRCF12PCA

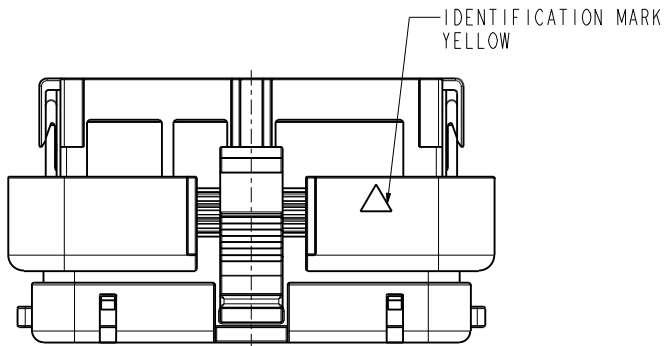

IDENTIFICATION MARK
YELLOW

HVRCF12PCB

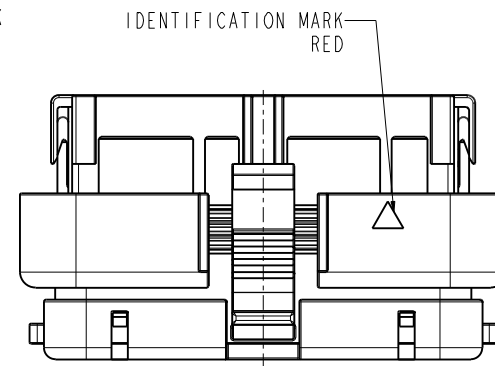

IDENTIFICATION MARK
RED

HVRCF12PCC

C-HVRCF12PCX

C-HVRCF12PCX

安费诺精密连接器(深圳)有限公司
Amphenol PCD Shenzhen

受控文件

2019年10月10日

SIZE A3	DWG NO. C-HVRCF12PCX	REV 1
CODE: 58982	SCALE: 3:2	SHEET 2 OF 2